



**Summer School 2017  
Registration and  
Course Information**

**Hartford Jt. 1 School District  
Summer School 2017  
At Lincoln Elementary**

**When: June 19 – July 14**

**Where: New Location! Lincoln Elementary**

**Register by Mail or Drop Off beginning today**

**Registration closes May 1, 2017**

# **Look What's New!**

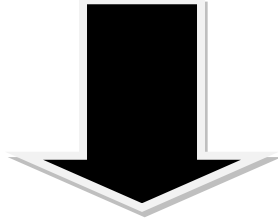

## **Summer School will be at Lincoln Elementary this summer!**

Due to construction at both Central and Rossman schools Hartford Jt. #1 summer school will be held at Lincoln Elementary this summer. Please pay special attention to any course changes and changes in drop off and pick up procedures, p. 5.

## **Still Almost New**

For the second year in a row, there will be no fees for almost all classes offered during summer school. In order to provide more access for students to continue their education in the summer we have dropped fees for almost all of our classes.

Check in the registration packet to see whether or not the course(s) you are looking for requires a fee.

-Jump Start Registration Packets will be coming home the week of May 2<sup>nd</sup>.

April, 2017

Dear Parent/Guardian:

The School District of Hartford Jt. 1 is pleased to announce the 2017 Summer School Program. Please read the following information very carefully.

1. **Use one registration form per child to register each child for summer school. Mail or drop off registrations will be accepted at Central Middle School from now through May 1. There will be no in-person registration. The cut off date for all registration is May 1.**
2. Determine classes by the grade your child will enter in fall. Each child may enroll in classes totaling up to four hours daily. You must fill out a registration sheet for each child; only use the form in this booklet for registration. Select the classes you want and an alternate class(es).  
  
**\*\* STUDENTS MUST CHOOSE CLASSES WHICH RUN CONSECUTIVELY – THERE MAY NOT BE TIME “GAPS” IN SCHEDULES. STUDENTS WHO ENROLL IN CLASSES WHICH END BEFORE THE NOON DISMISSAL MUST PROVIDE THEIR OWN TRANSPORTATION HOME FROM LINCOLN SCHOOL IMMEDIATELY FOLLOWING THE DISMISSAL TIME OF CLASS.**
3. This year’s regular summer program begins Monday, June 19 and ends Friday, July 14. No classes will be held on Tuesday July 4th. All classes will be held at Lincoln Elementary School. If your child will miss for any reason, please call Lincoln at 673-2100 to let us know.
4. **FEES** – Some classes will be charged a fee. The fee will vary based on the cost of materials for the class. **All fees must accompany the registration forms and are non-refundable**, unless the course is canceled. Checks should be made payable to Central Middle School. If you have a waiver for regular school year fees, your summer school fees are also waived. Notice of that fee waiver **MUST** accompany registration paperwork.
5. **All classes have enrollment limits and enrollment is on a first come, first served basis.** Courses may be added or dropped depending on teacher availability and minimal enrollment expectations.
6. **Residents of the School District of Hartford Jt. 1 will be given priority enrollment.** Students who are not residents of the Hartford Jt. 1 School District will pay a non-resident tuition fee of \$187, plus the fee for each class. Fees are based on the State of Wisconsin tuition formula.
7. **BUS TRANSPORTATION** will NOT be available.
8. Please keep a copy of your child’s enrollment. You will receive a **CANCELLATION EMAIL or PHONE CALL** if a class your child is registered for is canceled.
9. **MEDICATION needs will follow the Hartford Jt. No. 1 policy and be administered by the director or designee during summer school. Parents MUST fill out the appropriate paperwork before the start of summer school.**
10. **There will be a summer school open house Wednesday, June 14, 4:30 to 6:30 p.m.** You may come to school to acquaint your child(ren) with the school at that time. Class lists will also be available. Please bring your child(ren)’s schedule with you to help them find classrooms. Teachers will not be at the open house.

Summer school is designed to be an enjoyable learning atmosphere. All students enrolled are expected to adhere to the Hartford Jt. 1 code of conduct and be responsible learners. Students will be removed from summer school if their behavior interferes with the learning of others and will not have their fees refunded. We ask that toys, trading cards, CDs, mp3 players, hand-held video games, cell phones and other such objects not be brought to summer school. The District is not responsible for damaged, lost or stolen items. Thank you for your continued support of the summer school program. Please call Central Middle School, 673-8040 if you have any further questions.

Sincerely,



Matthew Haldemann  
Summer School Director

## Summer School 2017

# SPECIAL NOTICE

**THERE IS NO IN PERSON REGISTRATION FOR SUMMER SCHOOL!  
YOU WILL NEED TO MAIL OR DROP OFF YOUR REGISTRATION AT  
CENTRAL MIDDLE SCHOOL.**

I encourage you to register using the mail-in form at the back of this book as soon as possible. All registration closes on Monday, May 1.

You may mail the form with proper payment to this address:

Summer School Registration  
Central Middle School  
1100 Cedar St.  
Hartford, WI 53027

or drop it off at the Central Middle School beginning today.

Registration paperwork MUST include proper payment. If you wish to have your summer school fee waived, you must have a fee waiver on file with your regular school's office PRIOR to having your child(ren)'s fee waived, and send a copy along with your registration. See your school office to obtain a Fee Waiver Application if needed.

All classes have enrollment limits and enrollment is on a first-come, first-served basis. Classes may be added or dropped depending on teacher availability and minimal enrollment expectations, so it is important that you include alternative class choices on your child(ren)'s registration.

You will be contacted if we need to change your child(ren)'s classes or if classes are dropped because of insufficient enrollment.

The sooner you enroll your child(ren) the better; understand that many classes may fill quickly.

If you have questions, please contact me.

Sincerely,



Matthew Haldemann  
Summer School Director  
(262)673-3155 ext. 4121

# Student Drop off and Pick up

**These rules apply to summer school student drop off and pick up. Please read these rules and follow them for the safety of your children and those around your children!**

**Main Entrance Drop Off:** All students should be dropped off in the front. Please pull up as far as possible and drop students off so they get out on the right side of your car, the side facing the building.

## **Pick Up:**

### **K-3**

When picking up students in grades K-3 they will stay on the sidewalk closest to the building. Please pull forward as far as possible to allow them to get in. Refer to the map on page 6 to see exactly where your child will be.

### **Grades 4-5**

If you are picking up students in grades 4 and 5 use the parking lot by the cafeteria. Pull into the parking lot, loop north, and come around by the cafeteria to pick up your child. Then exit south through the maintenance road by shed.

### **Grades 6-8**

If you are picking up students in grades 6<sup>th</sup>-8<sup>th</sup>, please pick them up in the East lane, the lane that moves through the parking lot.

Drop off and pick up time is very busy, but if everyone follows the rules, we will have a safe and speedy process. The safety of our students is of great concern to us. There will be signs and cones to help with traffic flow, so please watch for these. Thank you for your anticipated cooperation.

If you are dropping off or picking up your children at any other times, (i.e. 9:00, 10:00, or 11:00) please drop them off and/or pick them up at Lincoln's West Lane, the lane closest to the school.

# Pick Up Map



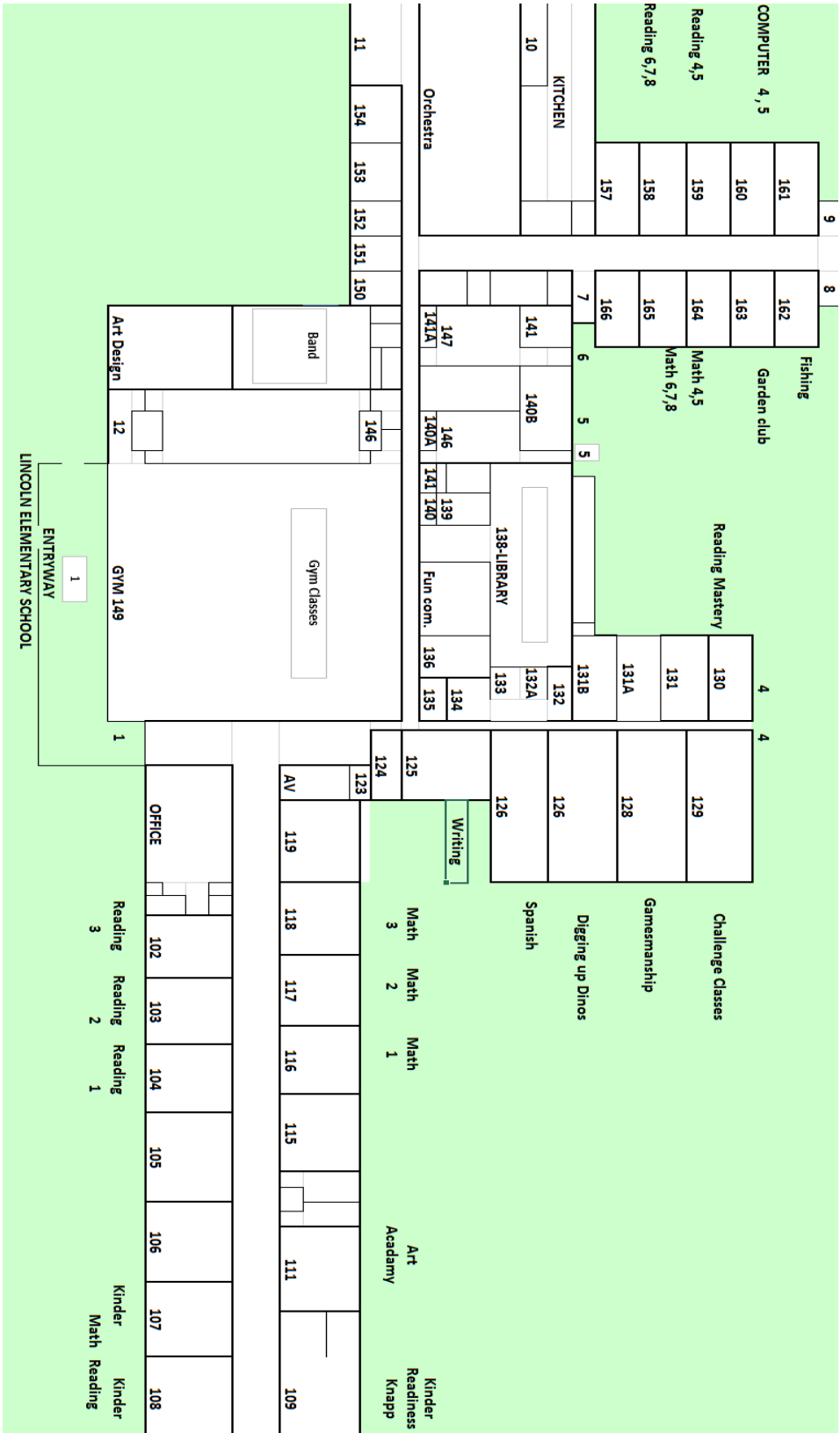

Lincoln Elementary

**Monday, June 19 to Friday, July 14**

## **OPEN COURSES**

**These courses are open to all students. They do not require teacher recommendations.**

**Reading Rockets** - Watch your child's reading ability rocket with this program. Reading Rockets is open to all students. They will be placed in targeted classes determined by their STAR reading scores. This is a two hour class that will take place from either 8-10 or 10-12 depending upon placement. Placement will be determined after all students have registered and they have finished their May STAR test. If you plan on having your child attend summer school all morning, and are only enrolling them in reading, please choose classes that would fill both the 8-10 and the 10-12 time frames. **NO FEE**

#RR 800 8:00 – 10:00

#RR 100 10:00 – 12:00

**Math Adventures** - Your child's math abilities will climb with this program. Math Adventures will be open to all students. They will be placed in a targeted program determined by their STAR math scores. This is a two hour class that will take place from either 8-10 or 10-12 depending upon placement. Placement will be determined after all students have registered and they have finished their STAR test. If you plan on having your child attend summer school all morning, and are only enrolling them in math, please choose classes that would fill both the 8-10 and the 10-12 time frames. **NO FEE**

#MA 800 8:00 – 10:00

#MA 1000 10:00 - 12:00

**MIDDLE SCHOOL CONNECTION** – THIS CLASS HAS BEEN MOVED TO THE JUMP START PORTION OF SUMMER SCHOOL.

## **Language Arts**

**YOUNG AUTHORS** - In this course the student will author and create stories that follow a pattern or format according to books they are studying. The student will have an opportunity to create pop-up books, lift and look books and class books. Students with a desire to create and write are encouraged to join. The second session is for students that have already taken the class or are in third grade. **NO FEE**

Gr. 2-3 10:00-12:00 #YA23-1000

**REV UP YOUR WRITING! (Grades 4-8)** - This course is for struggling writers who will learn how to become better authors of their own learning. They will be given the "power of the pen" as they explore, revise and think on paper. They will experience different types of writing, learn the steps of the writing process and learn how to use the district rubric to improve their writing. Tools will be provided to help them get ready to write, use their thinking while writing and reflect on how well their writing captures their ideas and learning. **NO FEE**

Gr. 4-8 8:00-10:00 #RW46-800



## Arts/Visual Arts

**ART ACADEMY** - This class is ideal for students who are interested and self-motivated at home to draw, paint or build with found objects and materials. The class will be directed in a variety of media. Emphasis will be placed on expression and experiencing the enjoyment of creating art.

Fee = \$8.00

|         |             |           |         |             |           |
|---------|-------------|-----------|---------|-------------|-----------|
| Gr. 3-4 | 8:00-9:00   | #A34-800  | Gr. 1-2 | 9:00-10:00  | #A12-900  |
| Gr. 1-2 | 11:00-12:00 | #A12-1100 | Gr. 3-4 | 10:00-11:00 | #A34-1000 |

**ART / DESIGN** - The course will include elements of art from our grades 5-8 curriculum.

Fee = \$8.00

|         |             |           |         |             |           |
|---------|-------------|-----------|---------|-------------|-----------|
| Gr. 5-8 | 8:00-9:00   | #P58-800  | Gr. 5-8 | 9:00-10:00  | #P58-900  |
| Gr. 5-8 | 10:00-11:00 | #P58-1000 | Gr. 5-8 | 11:00-12:00 | #P58-1100 |

## Music

### **ORCHESTRA**

**BEGINNING STRINGS** - This class is for all beginners in 6<sup>th</sup>, 7<sup>th</sup> or 8<sup>th</sup> grade who would like to learn how to play an orchestra instrument. There will be a concert on the last day of summer school in the auditorium from 8:15-8:45 a.m. Essential Elements 2000 for Strings (Book 1) Suzuki (Book 1) will be supplied to students. **NO FEE**

Gr. 6-8      8:00-9:00      #BS68-800

**INTERMEDIATE STRINGS** - In this class students will get the opportunity to receive a private lesson 2 or 3 times a week to improve their skills. This class is highly recommended to all 7th grade students who want to improve their skills and become better at their instrument. We will also do orchestra class 1-2 day a week depending on number of students participating. Class music will be provided. Suzuki (Book 2 or 3) will be supplied to students. **NO FEE**

Gr. 6-8      9:00-10:00      #IS68-900

**ADVANCED STRINGS** - In this class students will get the opportunity to receive a private lesson 2 or 3 times a week to improve their individual skills on their instrument. This class is highly recommended to all 8th grade students who want to improve their skills and become better at their instrument. We will also do orchestra class 1-2 day a week depending on number of students participating. Class music will be provided. Suzuki (Book 3 or 4) will be supplied to students.

**NO FEE**

Gr. 6-8      10:00-11:00      #AS68-1000

**STRING ORCHESTRA** - This class is designed for the 7th or 8th grade ORCHESTRA student that would like to learn 15-20 songs this summer. This class will have sheet music provided. We will play music in swing, rock and classical styles. There will be a concert on the last day of summer school in the auditorium from 11:00 11:30 a.m. This class is highly recommended for all 7th and 8th grade orchestra students. **NO FEE**

Gr. 6-8      11:00-12:00      #FO68-1100

## **BAND**

### **Marching, Pep and a Taste of Jazz (includes Color Guard)**

Open to students entering 7th and 8th grades, and have at least one year of experience on his/her instrument. All instruments welcome. Students must secure an instrument prior to the start of class. All other equipment is provided.

*Description:* This course features a mix of marching band, pep band, and jazz band experiences. Students prepare for upcoming parades in the fall, and learn the basics of pep and jazz band styles. This is a great way for students to experiment with a variety of musical genres while having fun in a relaxed, informal summertime setting.

*Note:* The marching band portion of the class includes Color Guard instruction. Students work with experienced high school-aged Color Guard members to learn a variety of flag and rifle maneuvers, as well as basic skills in writing flag and rifle routines.

Gr. 7-8      8:00- 9:00      #BBCS68-800

### **Beginning Band Classes**

Open to students entering their first year of playing a band instrument. No prior musical experience necessary. Students must secure an instrument prior to the start of class, as well as *Essential Elements, Book 1* for his/her specific instrument. This book is available for purchase through CMS.

*Description:* Students learn the basic skills that every successful beginning band student needs! Progress made in this course is typically the equivalent of one full trimester during the regular school year. Basic instrument care, cleaning and maintenance are also covered. This is a great way to kick-start students' middle school Band experience! **NO FEE**

|       |             |  |             |
|-------|-------------|--|-------------|
| Gr. 6 | 9:00-10:00  | Flute, Oboe, Bassoon, Percussion               | #BBP68-900  |
| Gr. 6 | 10:00-11:00 | Clarinet, Saxophone                            | #BBB68-1000 |
| Gr. 6 | 11:00-12:00 | Trumpet, French Horn, Trombone, Baritone, Tuba | #BBF68-1100 |

## **Science**

**DIGGING UP DINOSAURS** - A “hands-on” science program. In this course we will be “digging up” information about dinosaurs while participating in fun activities. We will be reading books, writing, playing games, making fossils, singing songs and measuring how long the dinosaurs were!  
**NO FEE**

|         |            |           |         |             |            |
|---------|------------|-----------|---------|-------------|------------|
| Gr. 2-3 | 8:00-10:00 | #DD23-800 | Gr. 2-3 | 10:00-12:00 | #DD23-1000 |
|---------|------------|-----------|---------|-------------|------------|

**SOMETHING FISHY** - This course will introduce students to the ecology of Wisconsin's fish species and the recreational sport of freshwater fishing. Students will study fish commonly found in the state's lakes and rivers while learning about the basic techniques and tools used to fish for these species. Activities will include field trips to local water bodies to study these habitats and fish for any panfish or game fish that may be present. Course topics will include fish identification and life histories, lake and river ecosystem structure, fishing equipment, censusing fish populations, fishing regulations and health advisories, ice fishing and much more. This course is more than an introduction to fishing. It will stress the ecological, scientific, legal and ethical aspects of the sport and foster a respect and an appreciation for fish and the ecosystems that support them. The course is suitable for beginners or those boys and girls already active in the sport of fishing that wish to learn more. **Student access to a fishing pole that he or she provides would be helpful.**

**NO FEE**

|         |            |           |         |               |            |
|---------|------------|-----------|---------|---------------|------------|
| Gr. 4-8 | 8:00-10:00 | #SF48-800 | Gr. 4-8 | 10:00 – 12:00 | #SF48-1000 |
|---------|------------|-----------|---------|---------------|------------|

**GARDEN CLUB** - Students will have the opportunity to create, maintain and harvest an actual garden. Students will learn about the history of gardens, health benefits, nutritional benefits and the community benefits of a garden. They will be able to grow plants, harvest them and take a portion home at the end of the season. Classes will begin during the initial 4 week session of summer school, 6/13 – 7/8. Classes will continue at Lincoln and Rossman once weekly at each garden respectively. Produce will be harvested at the end of the summer. Fee \$16.00  
 Gr. 5-8            8:00 – 10:00    #GC58-800                      Gr. 5-8 10:00 – 12:00                      #GC58-1000

## Family and Consumer Education

**KIDS IN THE KITCHEN** – NOT AVAILABLE THIS SUMMER DUE TO CONSTRUCTION

## Physical Education

**PHYSICAL EDUCATION** - This class will help students improve their coordination, strength, flexibility and basic physical education skills. Students will also work on good sportsmanship and their social skills as they explore new games like floor hockey, ping pong, scooter handball, scooter hockey and other recreational games. NO FEE

|         |             |            |                     |            |
|---------|-------------|------------|---------------------|------------|
| Gr. 1-2 | 8:00-9:00   | #PE12-800  | Gr. 3-4 9:00-10:00  | #PE34-900  |
| Gr. 1-2 | 10:00-11:00 | #PE12-1000 | Gr. 3-4 11:00-12:00 | #PE34-1100 |

**NEIGHBORHOOD PHYSICAL EDUCATION** - This class will help students improve their coordination, strength, flexibility and physical education skills. Students will learn games they can use in their neighborhood. NO FEE

|         |             |             |                     |             |
|---------|-------------|-------------|---------------------|-------------|
| Gr. 5-8 | 8:00-9:00   | #NPE58-800  | Gr. 5-8 9:00-10:00  | #NPE58-900  |
| Gr. 5-8 | 10:00-11:00 | #NPE58-1000 | Gr. 5-8 11:00-12:00 | #NPE58-1100 |

## Computers

**FUN WITH COMPUTERS** - This course is for students already familiar with the basics of working with computers. They must know how to use a mouse, be familiar with how to print a document and how to save a document. Computer skills will be taught using a variety of programs to benefit the young computer user. Students will color without crayons, type with cool letters, create a lemonade stand without leaving the room and work on money skills. Students will explore the magical world of computers and the things just for kids that can be found out there. This class is limited to 20 participants. NO FEE

|         |            |            |
|---------|------------|------------|
| Gr. 2-3 | 8:00-10:00 | #CLU23-800 |
|---------|------------|------------|

**LEARNING COMPUTERS** - Beginning computer skills, such as how to use a mouse, how to print and save and how to do basic word processing will be taught using a variety of programs to benefit the young computer user. Students will color without crayons, type with cool letters, create a lemonade stand without leaving the room and work on money skills. Students will explore the magical world of computers and the things just for kids that can be found out there. This course is intended to meet the needs of students who are just learning how to use a computer. This class is limited to 12 participants. **NO FEE**

Gr. 1            10:00-12:00    #CLU1-1000

**CREATIVE COMPUTERS** - This course is project based. Students will use their creative selves to make and take a variety of projects. The entire class will work together to create a project that will be displayed somewhere in Hartford. An example is a Wordle for a local business and a field trip to celebrate. **NO FEE**

Gr. 4-5            8:00-10:00    #C45-800

## Other Classes

**GAMESMANSHIP** - Students will learn and play games that stress being cooperative and promote gamesmanship. The ability to read directions, follow group rules and accept all possible outcomes of playing a game are stressed. Throw away the video games for some excellent real games! Games will be age and ability based. Students may only take this class once a day. **NO FEE**

Gr. 3-8            8:00-9:00    #G38-800

Gr. 3-8 9:00-10:00    #G38-900

Gr. 3-8            10:00-11:00    #G38-1000

Gr. 3-8 11:00-12:00    #G38-1100

**CHALLENGE LABS (GRADES 3-6)** - A “take off” from the Extended Learning Opportunities program. This class will be filled with games of strategy, mind benders and creativity exercises. It emphasizes higher level thinking skills. This class is limited to 20 participants. **NO FEE**

Gr. 3-6            8:00-9:00    #GT36-800

**DISCOVER THE WORLD (GRADES 1-4)** - Students will learn about different countries – play games, eat food, learn about the culture in general, find it on a map and much more! This class is limited to 20 participants. **NO FEE**

Gr. 1-2            9:00-10:00    #GT12-900

Gr. 3-4 10:00-11:00 #GT34-1000

**BRAINTEASERS (GRADES 5-8)** - Thinking OUTside the box! Students will learn to apply logic skills through solving puzzles and mental brainteasers. This class is limited to 20 participants.

**NO FEE**

Gr. 5-8            11:00-12:00    #GT58-1100

**ELEMENTARY SPANISH (GRADES 2-4)** - The goal of the Elementary Spanish summer school course is to introduce and develop the ability to communicate in a language other than English and gain knowledge and understanding of the Spanish culture, which in turn can help students understand their own language and culture better through means of comparison. The first level of Spanish will cover the following concepts: colors, alphabet, numbers, expressions, shapes and food. Both language and culture will be incorporated. Lessons are guided by the National Standards for Foreign Language Education. **NO FEE**

Gr. 2-4            8:00-9:00    #FL24-800

Gr. 2-4            11:00-12:00    # FL24-1100

**SECOND SUMMER SPANISH (GRADES 4-6)** - This class is for students who took Elementary Spanish last summer. The goal is to move students forward in developing the ability to communicate in Spanish. Both language and culture will be incorporated. Lessons are guided by the National Standards for Foreign Language Education. **NO FEE**

Gr. 4-6      9:00-10:00      #FL46-900                      Gr. 4-6      10:00-11:00      # FL46-1000

**INDEPENDENT SPANISH (GRADES 4-6)** - This class is for students who have completed Elementary and Second Summer Spanish and will run concurrently with those classes. Students will work independently in the Spanish classroom under the direction of the Spanish teacher while First and Second Summer Spanish are being taught. **NO FEE**

Gr. 4-6    8:00-9:00    #IS38-800                      Gr. 4-6    9:00-10:00    #IS38-900  
Gr. 4-6    10:00-11:00 #IS38-1000                      Gr. 4-6    11:00-12:00    #IS38-1100

**EXPLORING TECHNOLOGY EDUCATION (GRADES 7-8)**

-NOT AVAILABLE THIS SUMMER DUE TO CONSTRUCTION

**KINDERGARTEN READINESS READING (Entering Kindergarten)** - The course focuses on reading readiness. In addition students will learn age appropriate social skills and kindergarten classroom expectations. **NO FEE**

GR. K      8:00-10:00      #KR1-800      GR. K      10:00-12:00      #KR1-1000

**KINDERGARTEN READINESS MATH (Entering Kindergarten)** - The course focuses on math readiness. In addition students will learn age appropriate social skills and kindergarten classroom expectations. **NO FEE**

GR. K      8:00-10:00      #KM1-800      GR. K      10:00-12:00      #KM1-1000

# TEACHER RECOMMENDED COURSES

**Monday, June 19 to Friday, July 14**

These courses are open **ONLY** to students who have recommendations from their teachers.  
**A teacher recommendation letter must accompany any registration for these courses.**

**READING MASTERY COMPLETE PROGRAM (Entering Grades 1-3)** - This course is offered to students in Reading Mastery Complete Program during the school year, and by teacher recommendation **ONLY**. This course is designed around each student's placement level within the program at the end of the school year. Reading Mastery Complete Program focuses on phonics/decoding, comprehension, and language. **NO FEE**

Gr. 1-3      8:00-10:00      #RM13-800      Gr. 1-3

**CORRECTIVE READING (Entering Grades 4 & 5)** - This course is offered to current 3<sup>rd</sup> graders in Reading Mastery Complete Program and current 4<sup>th</sup> graders in Corrective Reading, and by teacher recommendation **ONLY**. This course is designed around each student's placement level within the programs at the end of the school year. Corrective Reading focuses on phonics/decoding and comprehension. **NO FEE**

Gr. 4-5      10:00-12:00      #CR45-1000

# Summer School Vacation Planner

If you already have planned a vacation for dates during summer school, please “X” under those dates and sign this form. It makes it tremendously easier for us if we know absences in advance.

Thank you for your cooperation.

## Summer School Dates

|                        |         |          |           |          |         |
|------------------------|---------|----------|-----------|----------|---------|
|                        | Monday  | Tuesday  | Wednesday | Thursday | Friday  |
|                        | June 19 | June 20  | June 21   | June 22  | June 23 |
| Anticipated<br>Absence |         |          |           |          |         |
|                        | Monday  | Tuesday  | Wednesday | Thursday | Friday  |
|                        | June 26 | June 27  | June 28   | June 29  | June 30 |
| Anticipated<br>Absence |         |          |           |          |         |
|                        | Monday  | Tuesday  | Wednesday | Thursday | Friday  |
|                        | July 3  | July 4   | July 5    | July 6   | July 7  |
| Anticipated<br>Absence |         | <b>X</b> |           |          |         |
|                        | Monday  | Tuesday  | Wednesday | Thursday | Friday  |
|                        | July 10 | July 11  | July 12   | July 13  | July 14 |
| Anticipated<br>Absence |         |          |           |          |         |

Student(s) Name(s): \_\_\_\_\_

(Please print neatly)

Parent/Guardian Name: \_\_\_\_\_

(Please print neatly)

Parent/Guardian Signature: \_\_\_\_\_

