

REFERENDUM

HJT1

HARTFORD JOINT #1 DISTRICT
VOTE NOVEMBER 6TH

Referendum Question

On November 6, 2018, the community of the Hartford Jt. #1 School District will be asked to vote on a referendum.

The referendum requests permission to borrow an amount not to exceed \$5,495,000 for constructing additions at Rossman Elementary and Lincoln Elementary Schools for instructional space, infrastructure and capital maintenance improvements, and related furnishings and equipment.



**Please
VOTE** 
November 6

REFERENDUM FACT SHEET

Building Capacity for the Future

What is the referendum for?

The referendum for additions at Rossman and Lincoln Elementary Schools will allow the District to have greater flexibility for instructional needs and build capacity for future growth. Additions will include:

- Four new classrooms at Rossman Elementary
- Four new classrooms at Lincoln Elementary
- Restrooms
- Multi-use storage space



How can I learn more?

Attend a Referendum Information Night:

- ◇ September 25 – Lincoln Elementary, 4:00-6:30 p.m.
- ◇ September 26 – Central Middle School, 4:00-6:30 p.m.
- ◇ September 27 – Rossman Elementary, 4:00-6:30 p.m.
- ◇ October 10 – Central Middle School PTO Night, 6:30 p.m.
- ◇ October 11 – Lincoln Elementary PTO Night, 6:30 p.m.
- ◇ October 17 – Rossman Elementary PTO Night, 6:30 p.m.
- ◇ October 18 – Recreation Center, Community Room A & B, 6:30 p.m.



Visit the Referendum section of the District website:
www.hartfordjt1.k12.wi.us



Call District Administrator Dr. Mark Smits at 262.673.3155



Go to myvotewi.gov to find your voting location



Lincoln Elementary

Proposed Floorplan

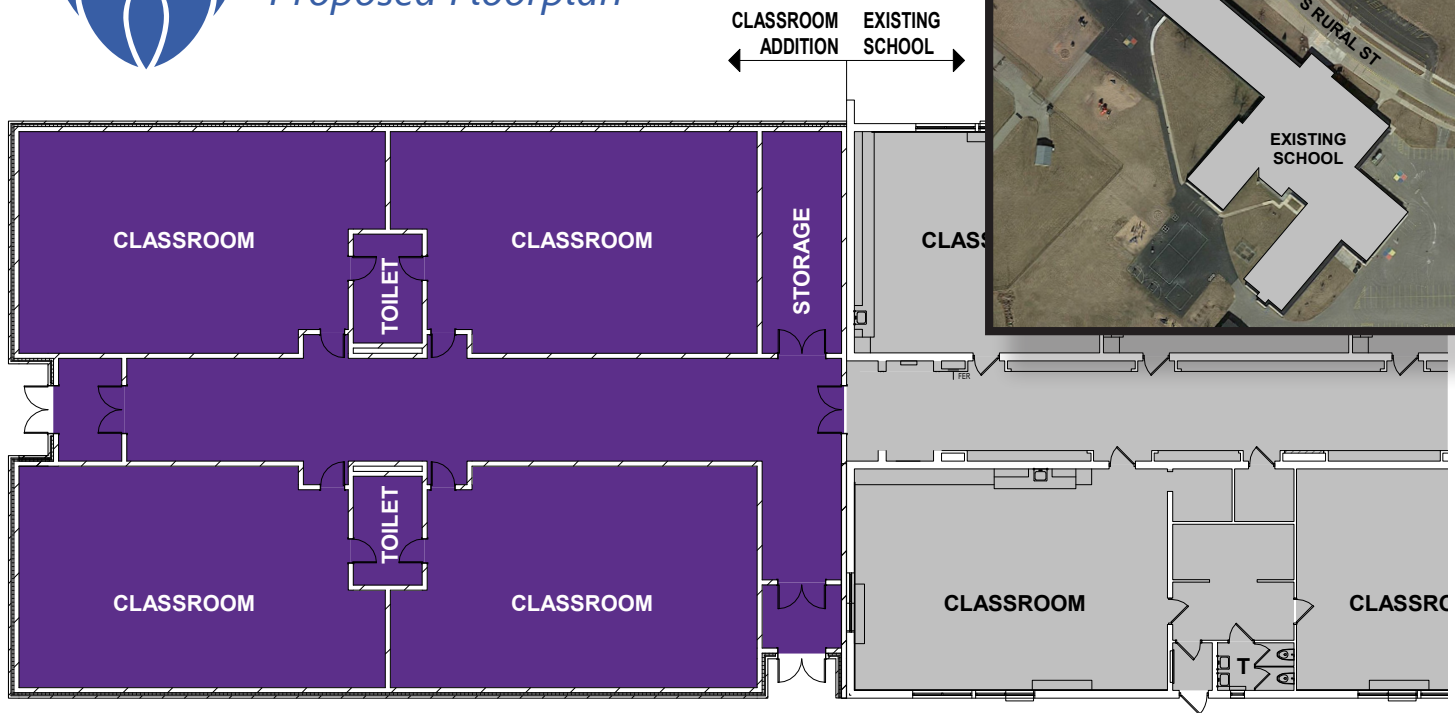

Rossman Elementary

Proposed Floorplan

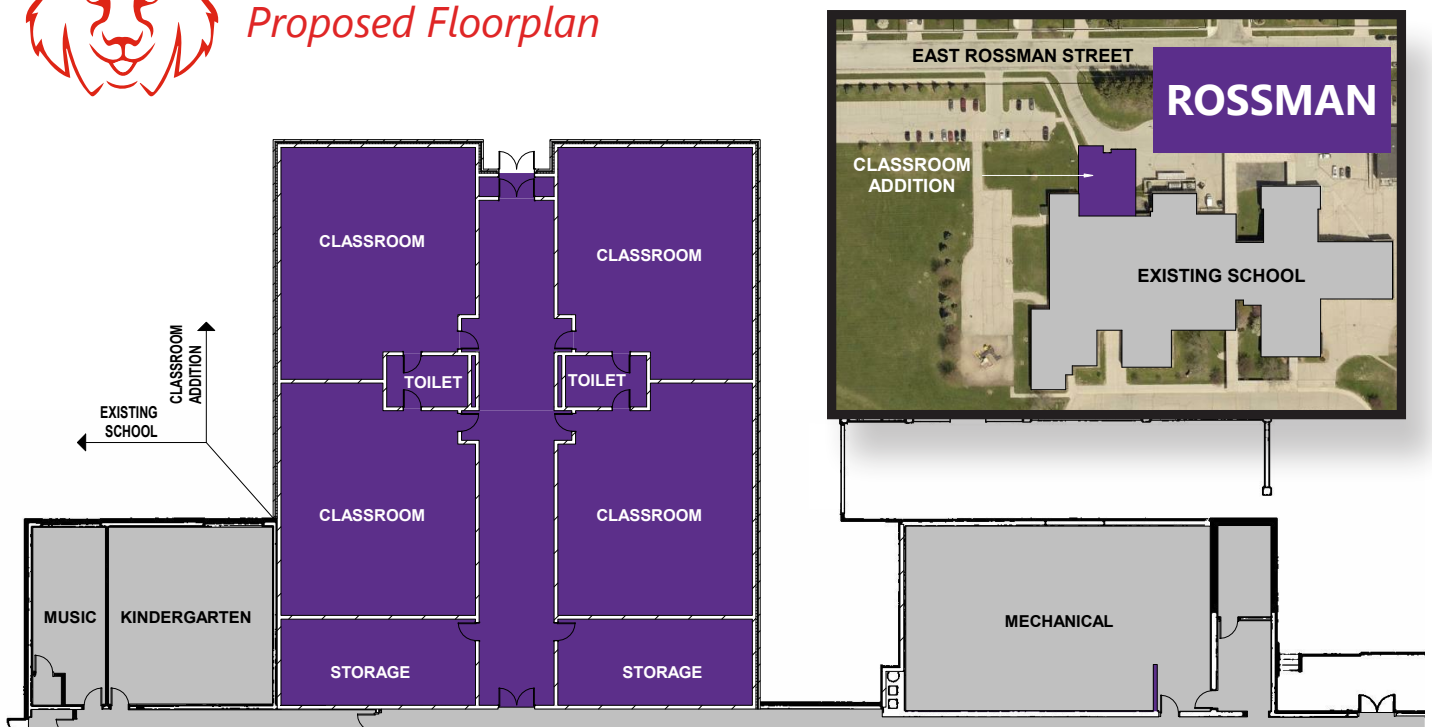

Why is this a good plan for our District now?

The School Board believes that now is a good time to add classroom space at Rossman and Lincoln Elementary Schools:



Fiscal Responsibility: Taxes Dropped Eight Years in a Row

Hartford Jt. #1 School District taxes have dropped for the past eight consecutive years, while enrollment is trending up. Due to our conservative approach to spending, we have the ability to add this referendum funding without increasing taxes.



Planning for Growth: Growing 31 Students Per Year

Enrollment in our District has grown from 1,508 in the 2002-03 school year to 2,012 today. This growth represents an average increase of approximately **31** students each year. We anticipate enrollment, with minor adjustments, to continue this slow and steady upward trend because of residential and business growth in the area. Adding classrooms at the elementary schools will help us build capacity for future enrollment increases at Hartford Jt. #1 School District.



Building on Success: Hartford is an Overachieving District

Hartford schools are great places for students to reach their highest academic potential! Both Lincoln and Rossman Elementary Schools received "Significantly Exceeds Expectations" ratings on the state report cards.

2,012
1,508



Enrollment growth
2002-03 to today

31

New students
per year since 2002-03



Excellence in action at Lincoln and Rossman Elementary Schools

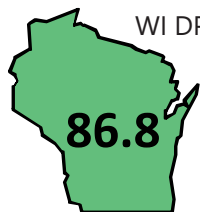

WI DPI School Report Card — Lincoln



Significantly Exceeds Expectations

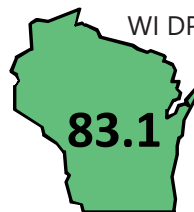

WI DPI School Report Card — Rossman



Significantly Exceeds Expectations

Lincoln Elementary: Keeping it Green

Lincoln students collected used-up markers that would have been sent to the landfill and recycled them through Crayola's ColorCycle Program. What a great way to practice recycling and sustainability at school and home!



Rossman Elementary: Creativity and Collaboration with S.T.E.M.

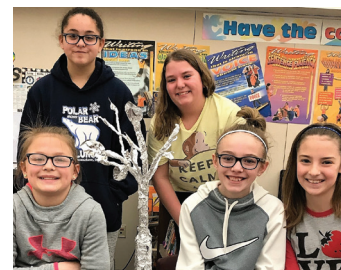

Mrs. Hanlon's classroom took on a S.T.E.M. challenge! Each group competed to see who could build the tallest structure using a single roll of aluminum foil.

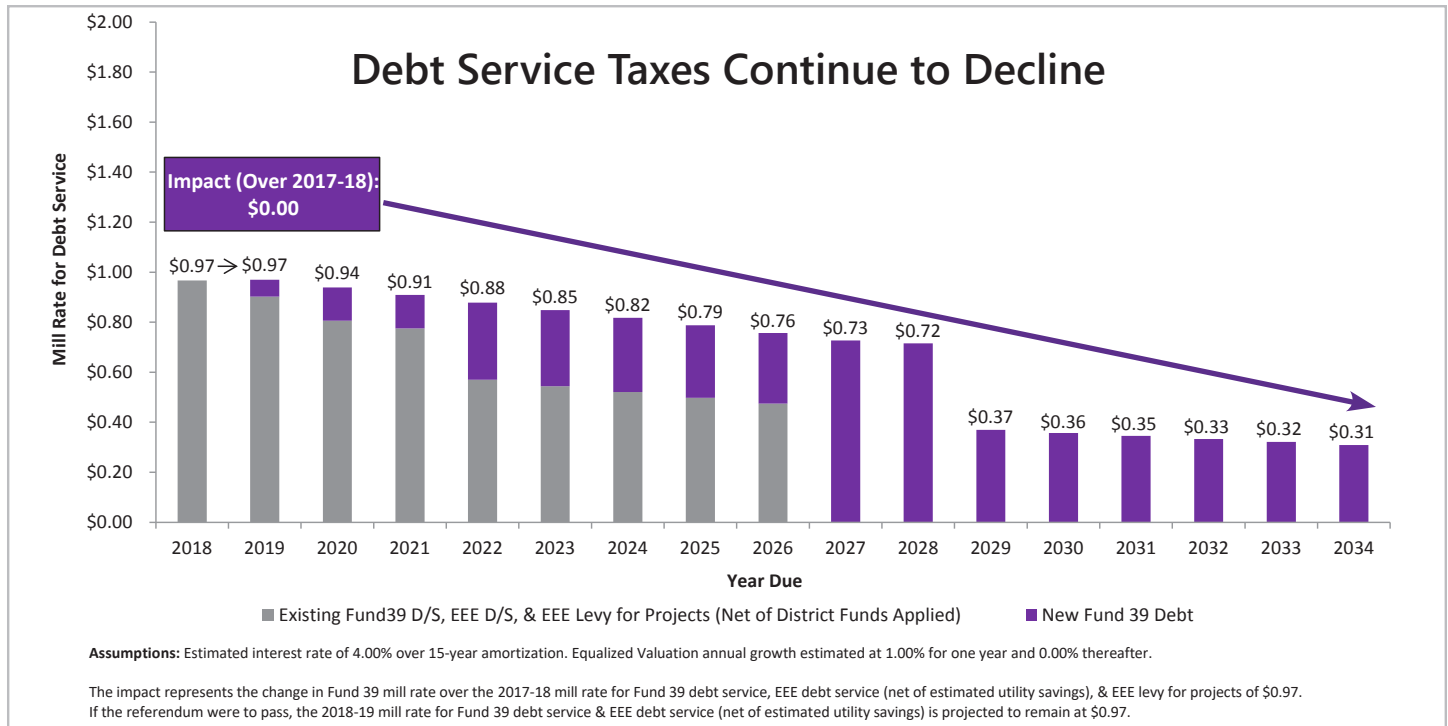

What is the tax impact of the referendum?

If the referendum is approved, **there would be no impact on current school tax rates over the life of the 15-year borrowing term.** This is because the District previously paid off building debt early. Given the District's history of fiscal responsibility and the current low interest-rate environment, the Board of Education believes this is a good time to move forward with this proposed referendum.



  	Estimated Tax Impact	
	Referendum Question: \$5,495,000	
	Fair Market Property Value	Annual Tax Impact (over 2017-18 school tax rates)
	\$100,000	\$0
	\$200,000	\$0
	\$300,000	\$0



**Please
VOTE
November 6**



When will the projects be finished?

If voters approve the measure, the District plans to break ground next spring, and the new classrooms will be ready for students by the 2019-20 school year.